

Jabra
Evolve 75e



User manual

© 2017 GN Audio A/S. All rights reserved. Jabra® is a trademark of GN Audio A/S. The Bluetooth® word mark and logos are registered trademarks owned by the Bluetooth SIG, Inc. and any use of such marks by GN Audio A/S is under license.

Made in China
MODEL: HSC070W/END040W



 **Bluetooth®**

Declaration of Conformity can be found on
www.jabra.com/CP/US/doc

1. Welcome.....	5
2. Jabra Evolve 75e overview	6
2.1 Included accessories	
3. How to wear	7
3.1 Getting the correct fit	
3.2 Attaching the EarWings	
3.3 Using the magnetic earbuds	
4. How to charge.....	11
4.1 What the LEDs mean	
5. How to connect.....	13
5.1 Headset on/off	
5.2 Connecting to a computer (Bluetooth adapter)	
5.3 Connecting to a computer (USB cable)	
5.4 Pairing with a smartphone	
6. How to use	16
6.1 Calls & music	
6.2 Active Noise Cancellation (ANC)	
6.3 Listen-in	
6.4 Headset voice guidance	
6.5 Siri or Google Now	
6.6 Multiple call handling	
6.7 Busylight	
6.8 Vibrate alert	

6.9	How to reset	
6.10	Firmware update	
7.	Support	27
7.1	FAQ	
7.2	How to care for your headset	

1. Welcome

Thank you for using the Jabra Evolve 75e. We hope you will enjoy it!

Jabra Evolve 75e features

- UC certified microphone technology
- Active Noise Cancellation (ANC) to eliminate disturbances
- Integrated Busylight to prevent interruptions
- Power battery to fuel all-day use (up to 12 hours on a 2 hour charge)
- Dual-connectivity to two Bluetooth devices, enabling you to take calls and listen to music from the same headset
- Up to 30 meters / 100 feet of wireless range for true mobility
- Vibrating call alert to ensure you never miss a call
- Listen-in feature: Hear the conversations around you, at the touch of a button

2. Jabra Evolve 75e overview

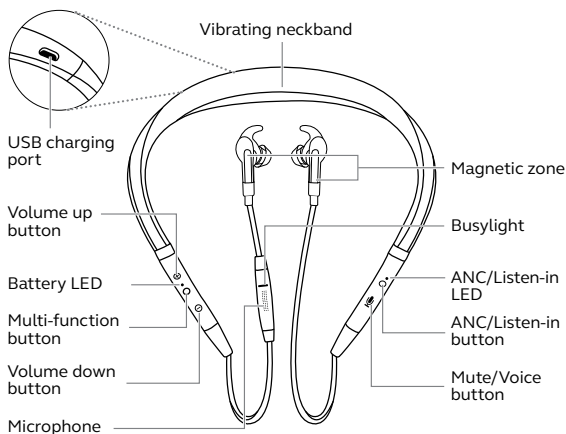

2.1 Included accessories

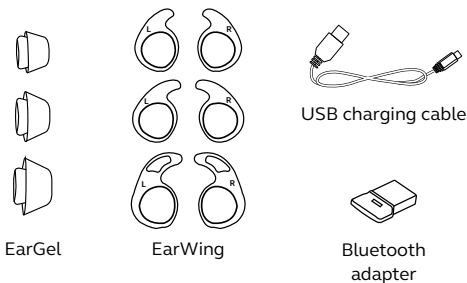

3. How to wear

Jabra Evolve 75e is designed to be worn around the neck.

For the optimal call experience, position the microphone as close to your mouth as possible.

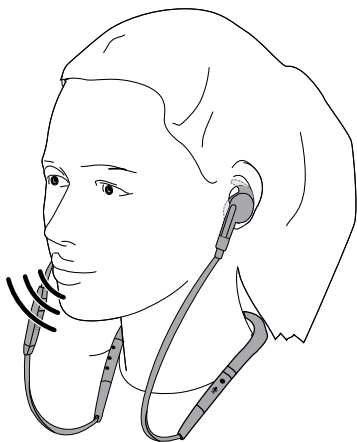

3.1 Getting the correct fit

The headset is supplied with three EarGel and EarWing sizes: large, medium and small.

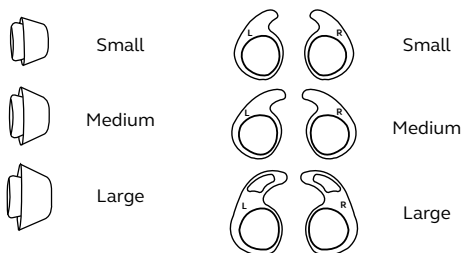

It is highly recommended to mix and match the different EarGel and EarWing sizes to find the best combination for your ear. The correct fit will feel tight and will seal out background noises.

3.2 Attaching the EarWings

To properly attach the EarWing, align the indent on the EarWing (as illustrated) with the ridge on the earbud, and stretch the EarWing over the earbud. It will fit perfectly in the groove when properly attached.

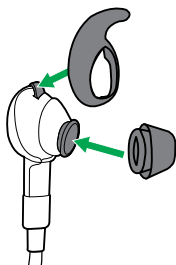

3.3 Using the magnetic earbuds

The earbuds are magnetic, and connect together for convenient cable and power management. When the earbuds are connected, your music will be paused or your call will be ended. Go to section 6.1. for more information.

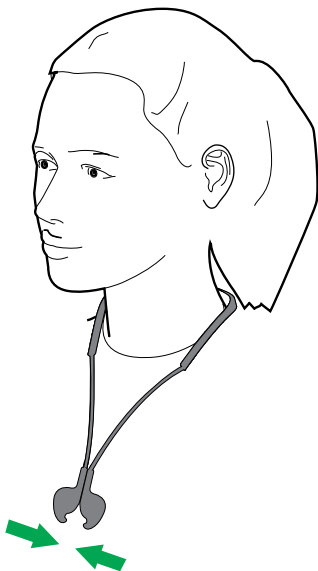

4. How to charge

To charge the headset, connect a USB charging cable to the USB charging port on the neckband. It is recommended to charge the headset using the supplied Jabra charging cable, however it is possible to charge the headset using your smartphone charger.

It takes approx. 2 hours to fully charge the headset.

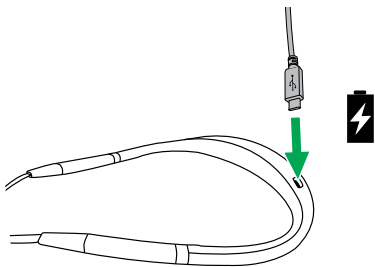

Note: Always clean and dry the USB charging port before charging the headset. It is recommended to recharge the headset at least once a month.

4.1 What the LEDs mean

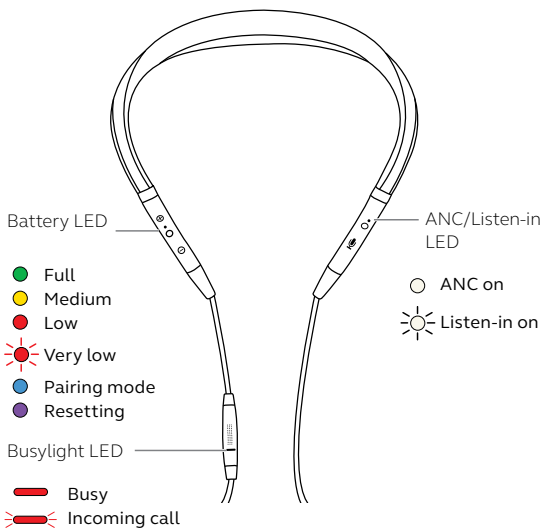

5. How to connect

5.1 Headset on/off

On: Hold the **Multi-function** button for 1 second. The LED will flash green, and the neckband will vibrate.

Off: Hold the **Multi-function** button for 3 seconds. The LED will flash red, and the neckband will vibrate.

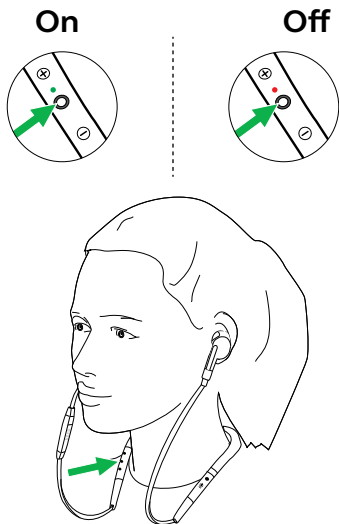

5.2 Connecting to a computer (Bluetooth adapter)

1. Insert the Bluetooth adapter (Jabra Link 370) into your computer.

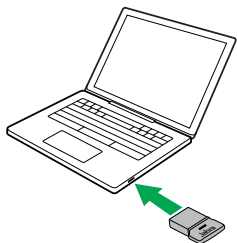

2. Hold (1 sec) the **Multi-function** button on the headset to power it on. The headset and the Bluetooth adapter are pre-paired and will automatically connect.

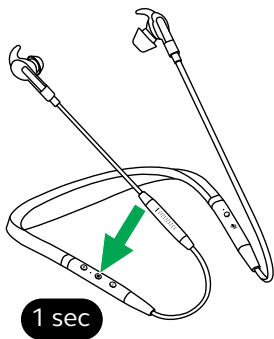

5.3 Connecting to a computer (USB cable)

1. Ensure the headset is powered on.
2. Plug the headset into a USB port on your computer using the supplied USB cable.

5.4 Pairing with a smartphone

1. Ensure the headset is powered off, and then hold (3 secs) the **Multi-function** button until the LED flashes blue and you hear an announcement in the headset.

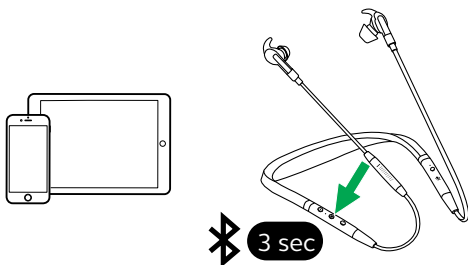

2. Wear the headset and follow the voice-guided pairing instructions.

6. How to use

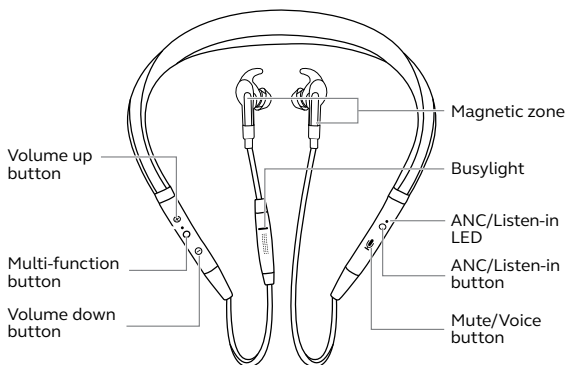

6.1 Calls & music

Calls & music	
Turn on headset	Hold (1 sec) the Multi-function button
Turn off headset	Hold (3 sec) the Multi-function button
Play/pause music	Hold (1 sec) the Multi-function button (smartphone only)
Answer/end call	Press the Multi-function button when not on a call
Reject call	Double-tap the Multi-function button

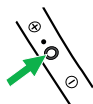



Answer/end call or play/pause music

Detach/attach the Magnetic earbuds

Adjust volume

Press the **Volume up** or **Volume down** button, when listening to music or on a call

Skip track forward

Hold (1 sec) the **Volume up** button (smartphone only)

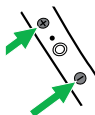

Skip track backwards

Hold (1 sec) the **Volume down** button (smartphone only)

Battery status

Press the **Volume up** or **Volume down** button, when not listening to music or on a call

Busylight on/off

Press both the **Volume up** and **Volume down** buttons simultaneously

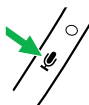

Siri or Google Now

Press the **Mute/Voice** button, when not on a call

Mute/un-mute microphone

Press the **Mute/Voice** button, when on a call

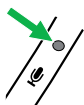

ANC on/off

Press the **ANC/Listen-in** button

Listen-in on/off

Hold (2 secs) the **ANC/Listen-in** button

6.2 Active Noise Cancellation (ANC)

The headset uses Active Noise Cancellation (ANC) to eliminate outside disturbance, allowing you to fully focus.

Press the **ANC/Listen-in** button to turn ANC on or off.

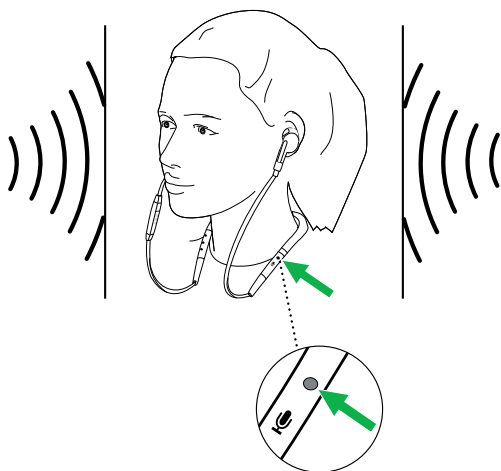

6.3 Listen-in

Listen-in enables you to hear your surroundings or engage in conversations without needing to remove the headset.

Hold (2 secs) the **ANC/Listen-in** button to turn Listen-in on or off.

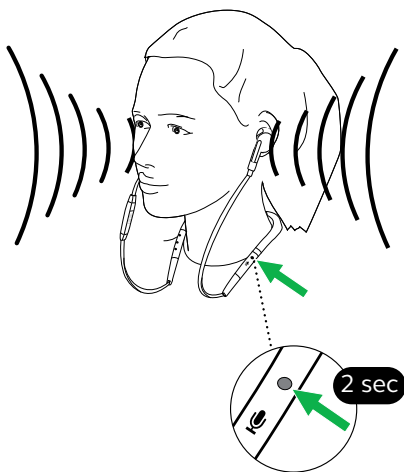

6.4 Headset voice guidance

Headset voice guidance are announcements intended to guide you or give headset status updates (e.g. connection and battery status).

How to turn voice guidance On/Off

Voice guidance is enabled by default.

Voice Guidance On:

Ensure the headset is powered on, and then hold the **Mute/Voice** button for 5 seconds.

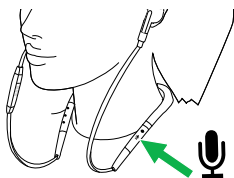

Voice Guidance Off:

Ensure the headset is powered on, and then hold the **Mute/Voice** button for 5 seconds.

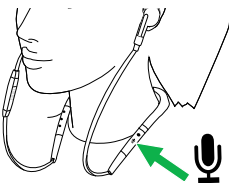

6.5 Siri or Google Now

Phone voice commands enable you to speak to Siri or Google Now on your smartphone using your headset. For more information on using Siri or Google Now, please refer to your smartphone's user manual.

Phone voice commands

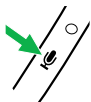

Activate Siri or Google Now (phone dependent)

Press the **Mute/Voice** button, when not on a call

6.6 Multiple call handling

The headset can answer or reject calls when you are already on a call.

Multiple call handling	
End current call and answer incoming call	Press the Multi-function button
Put current call on hold and answer incoming call	Hold (1 secs) the Multi-function button
Switch between held call and active call	Hold (1 secs) the Multi-function button
Reject incoming call, when on a call	Double-tap the Multi-function button

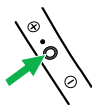

6.7 Busylight

The Busylight on the headset lets others know when you are busy, or on a call.

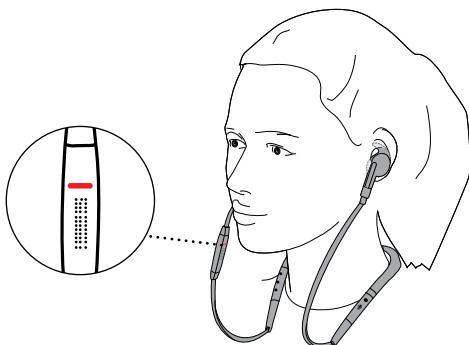

Busylight

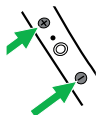

Busylight on/
off

Press both the **Volume up** and **Volume down** buttons simultaneously to turn the Busylight on/off

To disable (or re-enable) the Busylight function, hold both the Volume up and Volume down buttons simultaneously for 3 seconds.

6.8 Vibrate alert

The headset will vibrate whenever it is powered on/off, connected to your smartphone or computer, or when there is an incoming call.

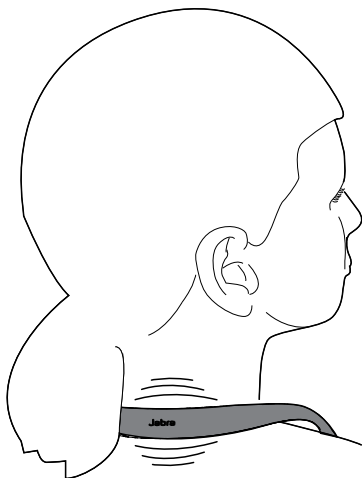

6.9 How to reset

Resetting the headset clears the list of paired devices and all headset settings.

After resetting, it is necessary to re-pair the headset to your smartphone or to your Bluetooth adapter (Jabra Link 370). Please note that Jabra Direct is required to re-pair the headset to the Bluetooth adapter.

Reset



Reset the pairing list

Ensure the headset is powered on and you are not on a call. Then simultaneously hold the **Volume up** button and the **Multi-function** button for 5 seconds. You will then need to re-pair the headset.

6.10 Firmware update

Firmware updates improve performance, or add new functionality to Jabra devices.

1. Connect the Jabra Evolve 75e to a computer using the USB cable or Jabra Link 370.
2. Install Jabra Direct on your computer, or Suite for Mac on your Mac.
3. Use Jabra Direct or Suite for Mac to check for the latest firmware updates.

7. Support

7.1 FAQ

View the FAQs on [Jabra.com/Evolve75e](https://www.jabra.com/Evolve75e)

7.2 How to care for your headset

- Always store the headset with the power off and safely protected.
- Avoid storage at extreme temperatures (above 50°C/122°F or below -10°C/14°F). This can shorten battery life and may affect the earbuds.
- Regularly clean the metal mesh on each earbud to avoid them becoming blocked.

jabra.com/evolve75e